



FOR SALE

MARKET

PRIME DEVELOPMENT LAND

3530 199 Street NW, Edmonton, AB

RE/MAX Excellence Commercial Division is pleased to present a development opportunity in Southwest Edmonton.

This strategically located site offers significant frontage onto 199 Street (Edgemont Blvd) and is surrounded by established and emerging multifamily developments, making it a prime candidate for high-density residential or mixed-use construction.

Positioned in a rapidly growing area, this property provides excellent connectivity to major transportation routes and is in close proximity to key amenities, schools, retail, and recreation. The location supports strong development potential, with a setting that blends suburban convenience and urban-style density.

This rare offering presents developers with the chance to shape a prominent project in one of Edmonton's most dynamic corridors.

Site Area	± 17.014 Acres
Zoning	AG (Agriculture)
Neighbourhood	Edgemont
Legal	Plan 3119MC Lot A

RE/MAX
COMMERCIAL
RE/MAX EXCELLENCE
COMMERCIAL DIVISION

DON PATTERSON
Managing Partner/Broker Owner

📞 (780) 243-1767
✉️ don.patterson@remaxexcellence.com

JEFF RUSSELL
Vice President, Investments

📞 (780) 667-1765
✉️ Jeff@russellrealestate.pro

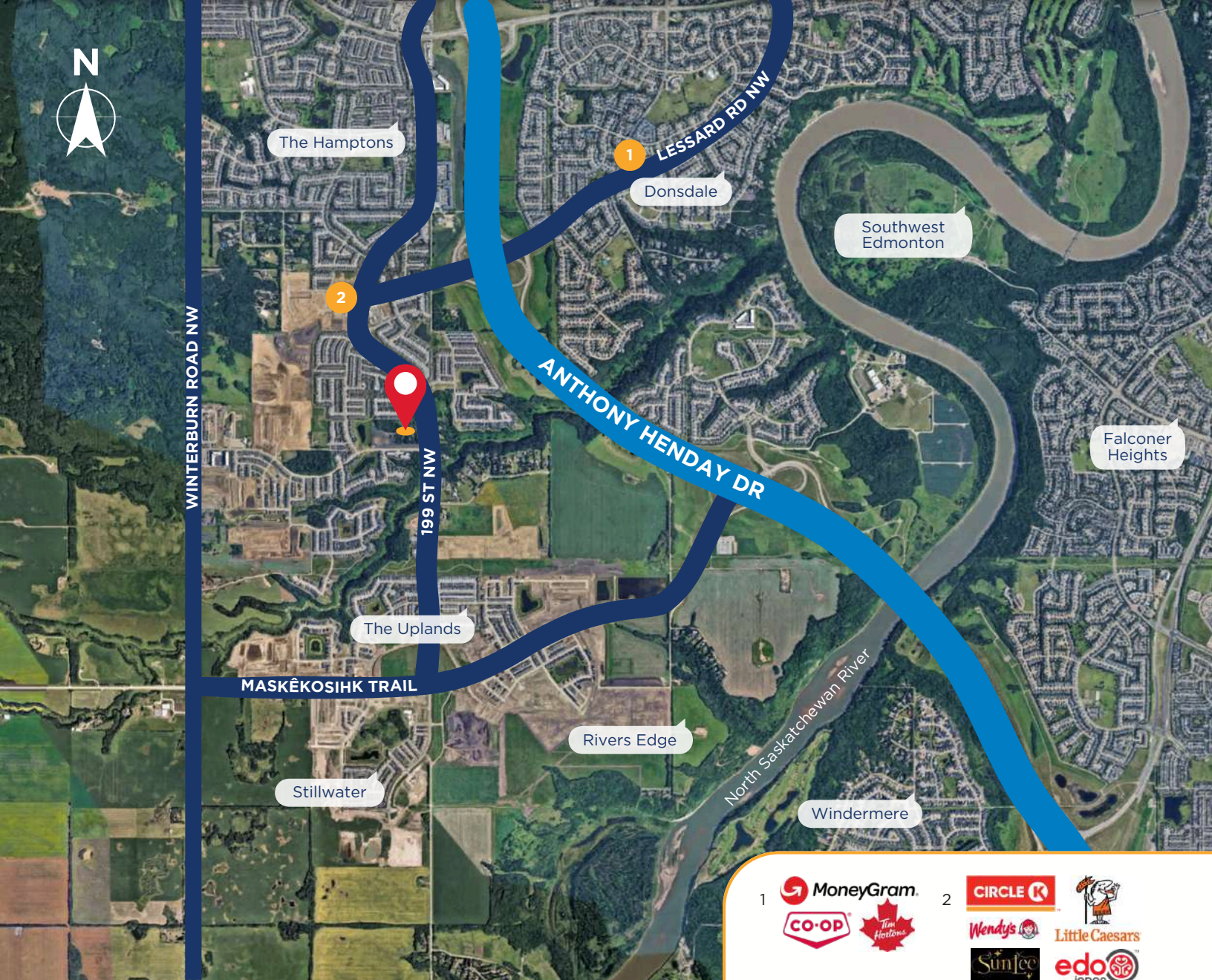

DEMOGRAPHICS

3530 199 Street NW, Edmonton, AB



POPULATION

5,050
Edgemont Area



COMMUTE

93.7%
By Car



HOUSING

Owner: 84.3%
Renter: 15.7%



INCOME

Individual: \$63.2k
Family: \$143.5k



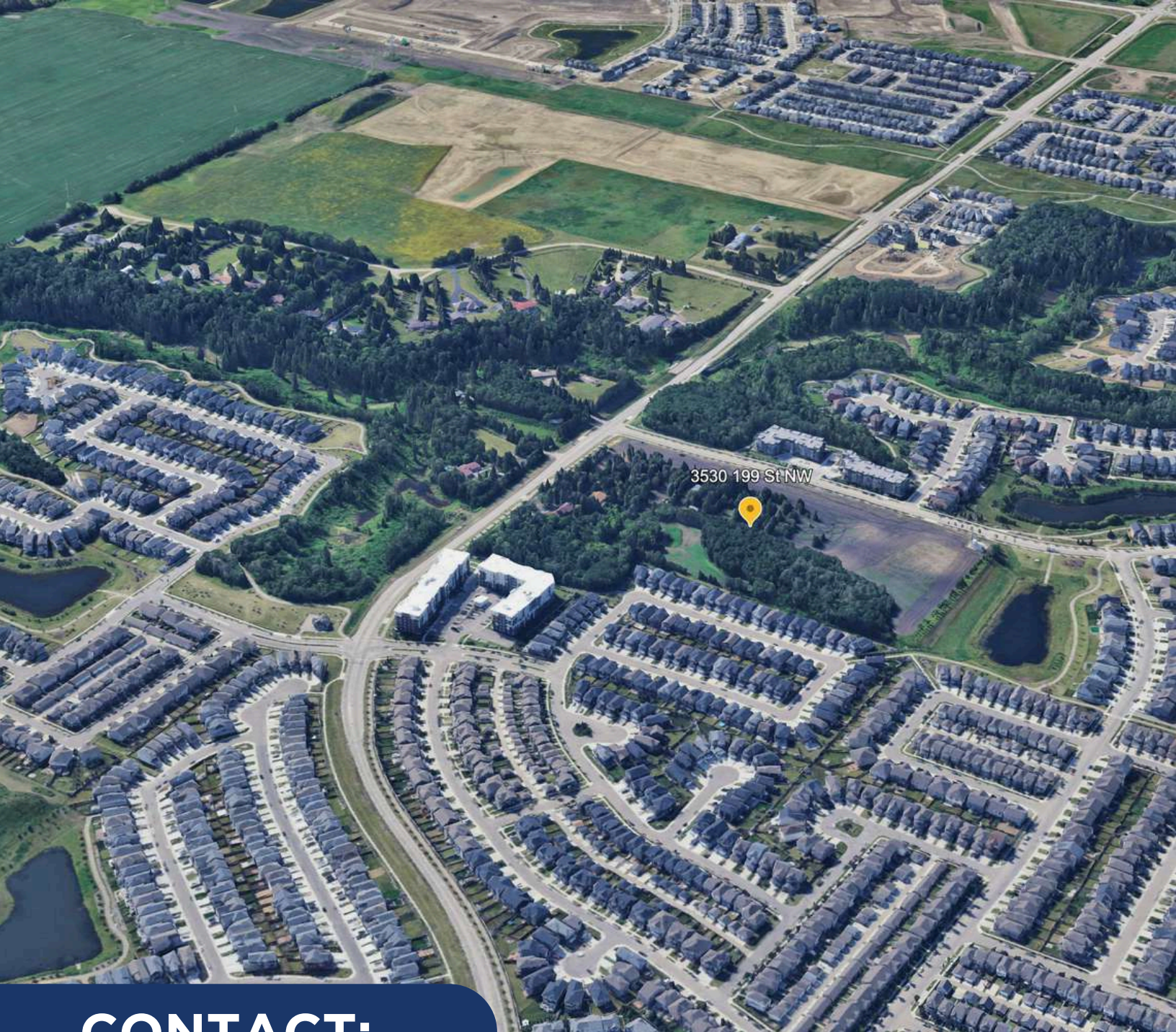

CONTACT:

DON PATTERSON

Managing Partner/Broker Owner

📞 (780) 243-1767

✉️ don.patterson@remaxexcellence.com

JEFF RUSSELL

Vice President, Investments

📞 (780) 667-1765

✉️ Jeff@russellrealestate.pro



201, 5607 - 199 Street , Edmonton, AB T6M 0M8 | commercialyeg.ca

This brochure is for general informational purposes only. No warranty is made regarding the accuracy of the information, which is subject to errors, omissions, price changes, and withdrawal without notice. The information contained herein was obtained from sources deemed to be reliable and is believed to be true; it has not been verified, and as such, cannot be warranted nor form a part of any future contract. All measurements should be independently verified by the Purchaser/Tenant. RE/MAX Excellence Commercial Division office is independently owned and operated, and shall not be held liable for any loss and damages arising from information provided in this brochure. Statistics are sourced from Neighbourhood Profiles Federal Census 2021 by The City Of Edmonton, and locallogic.co as of May 2023. Stats are subjective to change; Please call for more information.